

NOTE: ITEMS MARKED '*' INDICATE SHIMS
 NOT REQUIRED WITH SHIMLESS DIFFUSER
 PART No: 08391076A [ITEM #76a]

Title **PUMPENG 8kW
 HIGH HEAD SUBMERSIBLE
 DEWATERING PUMP**

Rev. 2 Sept. '07

SUPPLIED BY:

INFORMATION ON THIS DOCUMENT IS SUBJECT TO CHANGE WITHOUT NOTICE



Unit 2/26 Ilda Rd.
 Canning Vale. W.A. 6155
 PO Box 1340
 Canning Vale. W.A. 6970

Ph: 61 8 9256 3182
 Fax: 61 8 9256 3867
 Email: sales@pumpeng.com.au
 Web: www.pumpeng.com.au

WITHOUT LIMITING THE RIGHTS UNDER
 COPYRIGHT, NO PART OF THIS DOCUMENT
 MAY BE REPRODUCED, STORED IN OR
 INTRODUCED TO A RETRIEVAL SYSTEM,
 OR TRANSMITTED IN ANY FORM OR BY
 ANY MEANS, OR FOR ANY PURPOSE,
 WITHOUT THE EXPRESS WRITTEN
 PERMISSION OF PUMPENG.

ACCESSORIES		
PART No.	DESCRIPTION	CONSISTS OF:
08SK	8kW Rotor Shaft Kit	Item #62C - O-Rings Item #62B - Sleeve Item #62D - Circlip

ACCESSORIES		
PART No.	DESCRIPTION	CONSISTS OF:
08BSK	8kW Bottom Suction Kit	Item #65A - Btm. Suct. Strainer Item #65B - Half Strainer Item #65C - Bolt

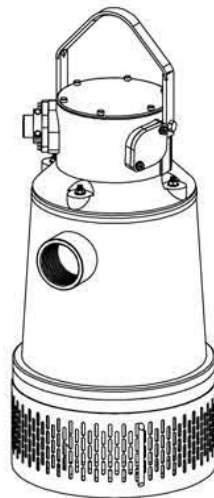

ACCESSORIES		
PART No.	DESCRIPTION	CONSISTS OF:
08RK	8kW Repair Kit	Item #2 - Seal Item #13 - Seal Item #103 - Circlip Item #122 - Bearing Item #123 - Bearing + 1x O-Ring Kit #08OK

ACCESSORIES		
PART No.	DESCRIPTION	CONSISTS OF:
08OK	8kW O-Ring Kit	Item #33b - O-Ring Item #104 - O-Ring Item #105 - O-Ring Item #107 - O-Ring Item #111 - O-Ring Item #112 - O-Ring Item #113 - O-Ring Item #114 - O-Ring Item #115 - O-Ring

ENHANCED PERFORMANCE PARTS

ITEM No.	PART No.	DESCRIPTION	MATERIAL	QTY.	ITEM No.	PART No.	DESCRIPTION	MATERIAL	QTY.
1	08120001	Impeller Nut	S/Steel	1	71	08201071	Diffuser Disc	Poly	1
2	08128002	Mechanical Seal	TC	1	72	08130072	Screw Inspection	S/Steel	3
11	08120011	Shim Impeller 0.3mm	S/Steel	-	74	08200074	Stator 415V	-	1
11a	08120011A	Shim Impeller 1.5mm	S/Steel	-	74a	08200074A	Stator 1000V	-	1
12	08120012	Shim Diffuser 0.3mm	S/Steel	-	76	08291076	Diffuser	Alum/Poly	1
12a	08120012A	Shim Diffuser 0.5mm	S/Steel	-	76a	08291076A	Diffuser Shimless	Alum/Poly	1
13	08128002	Mechanical Seal	TC	1	76b	08190076B	Diffuser Adjusting Screw	Aluminium	6
21	08190021	Cable Entry Unit 14-22mm	Aluminium	1	82	08130082	Impeller Key	S/Steel	1
21a	08190021A	Junction Box Flange	Aluminium	1	84	08120084	Stud	S/Steel	4
21b	08190021B	Cable Flange Gasket	N.A.G.	1	85	08120085	Stud	S/Steel	6
27	08120027	Sleeve Washer 14-16mm	S/Steel	2	86a	08120086A	Stud	S/Steel	6
27a	08120027A	Sleeve Washer 16-18mm	S/Steel	2	86b	08120086B	Stud	S/Steel	4
27b	08120027B	Sleeve Washer 18-20mm	S/Steel	2	87	08120087	Screw	S/Steel	4
27c	08120027C	Sleeve Washer 20-22mm	S/Steel	2	88	08120088	Screw	S/Steel	2
31	08102031	Seal Sleeve 14-16mm	Rubber	1	89	08120089	Screw	S/Steel	2
31a	08102031A	Seal Sleeve 16-18mm	Rubber	1	90	08120090	Screw	S/Steel	11
31b	08102031B	Seal Sleeve 18-20mm	Rubber	1	91	08120091	Screw	S/Steel	4
31c	08102031C	Seal Sleeve 20-22mm	Rubber	1	93	08120093	Screw	S/Steel	1
33	08190033	Junction Box	Aluminium	1	95	08120095	Nut	S/Steel	4
33a	08190033A	Junction Box Cover	Aluminium	1	96	08120096	Nut	S/Steel	48
33b	08190033B	O-Ring Junction Box	NBR	1	97	08120097	Washer	S/Steel	4
34	08630034	Outer Casing	S/Steel	1	98	08120098	Washer	S/Steel	1
35	08630035	Stator Casing	Aluminium	1	101	08120101	Washer	S/Steel	42
36	08190036	Bearing Housing Lower	Aluminium	1	102	08120102	Washer Spring	S/Steel	4
41	08191041	Oil Housing	Alum/Poly	1	103	08120103	Circlip	HTS	1
43	08291043	Suction Cover HT	Alum/Poly	1	104	08100104	O-Ring	NBR	3
44	08190044	Bearing Housing Upper	Aluminium	1	105	08100105	O-Ring	NBR	1
45	08190045	Bearing Cover	Aluminium	1	107	08100107	O-Ring	NBR	1
56	08710056	Impeller Lower HT - Std.	Cr27	1	111	08100111	O-Ring	NBR	1
56a	08710056A	Impeller Lower c/w Bush	Cr27	1	112	08100112	O-Ring	NBR	1
56b	08710056B	Impeller Lower Neck Bush	Cr16	1	113	08100113	O-Ring	NBR	1
57	08710057	Impeller Upper HT	Cr27	1	114	08100114	O-Ring	NBR	1
62	08100062	Rotor - Standard	S/Steel	1	115	08100115	O-Ring	NBR	1
62a	08100062A	Rotor - Modified for Shaft Sleeve option	S/Steel	1	117	08100117	Washer Bearing Support	S/Steel	1
62b	08100062B	Shaft Sleeve - suit Modified Rotor Shaft	S/Steel	1	122	08100122	Bearing Upper	-	1
62c	08100062C	O-Ring - suit Shaft Sleeve	NBR	2	123	08100123	Bearing Lower	-	1
62d	08120062D	Shaft Sleeve - Circlip	S/Steel	2	126	08100126	Earthing Plate	S/Steel	1
63	08102063	Lead Through	Rubber	1	131	08100131	Handle	Galv. St.	1
65	08100065	Standard Strainer	Galv/St	1	139	GP2400139	Anode	Zinc	4
65a	08100065A	Bottom Suction Strainer	Galv/St	1	140	08600140	Carry Handle	Galv/St	1
65b	08100065B	Half Strainer	Galv/St	1	141	08120141	Screw	S/Steel	6
65c	08100065C	Bolt	Galv/St	3	142	08120142	Washer	S/Steel	6

Title **PUMPENG 8kW
HIGH HEAD SUBMERSIBLE
DEWATERING PUMP**

SUPPLIED BY:

Rev. 3 Sept. '07

INFORMATION ON THIS DOCUMENT IS SUBJECT TO CHANGE WITHOUT NOTICE



Unit 2/26 Ilda Rd.
Canning Vale. W.A. 6155
PO Box 1340
Canning Vale. W.A. 6970

Ph: 61 8 9256 3182
Fax: 61 8 9256 3867
Email: sales@pumpeng.com.au
Web: www.pumpeng.com.au

WITHOUT LIMITING THE RIGHTS UNDER COPYRIGHT, NO PART OF THIS DOCUMENT MAY BE REPRODUCED, STORED IN OR INTRODUCED TO A RETRIEVAL SYSTEM, OR TRANSMITTED IN ANY FORM OR BY ANY MEANS, OR FOR ANY PURPOSE, WITHOUT THE EXPRESS WRITTEN PERMISSION OF PUMPENG.

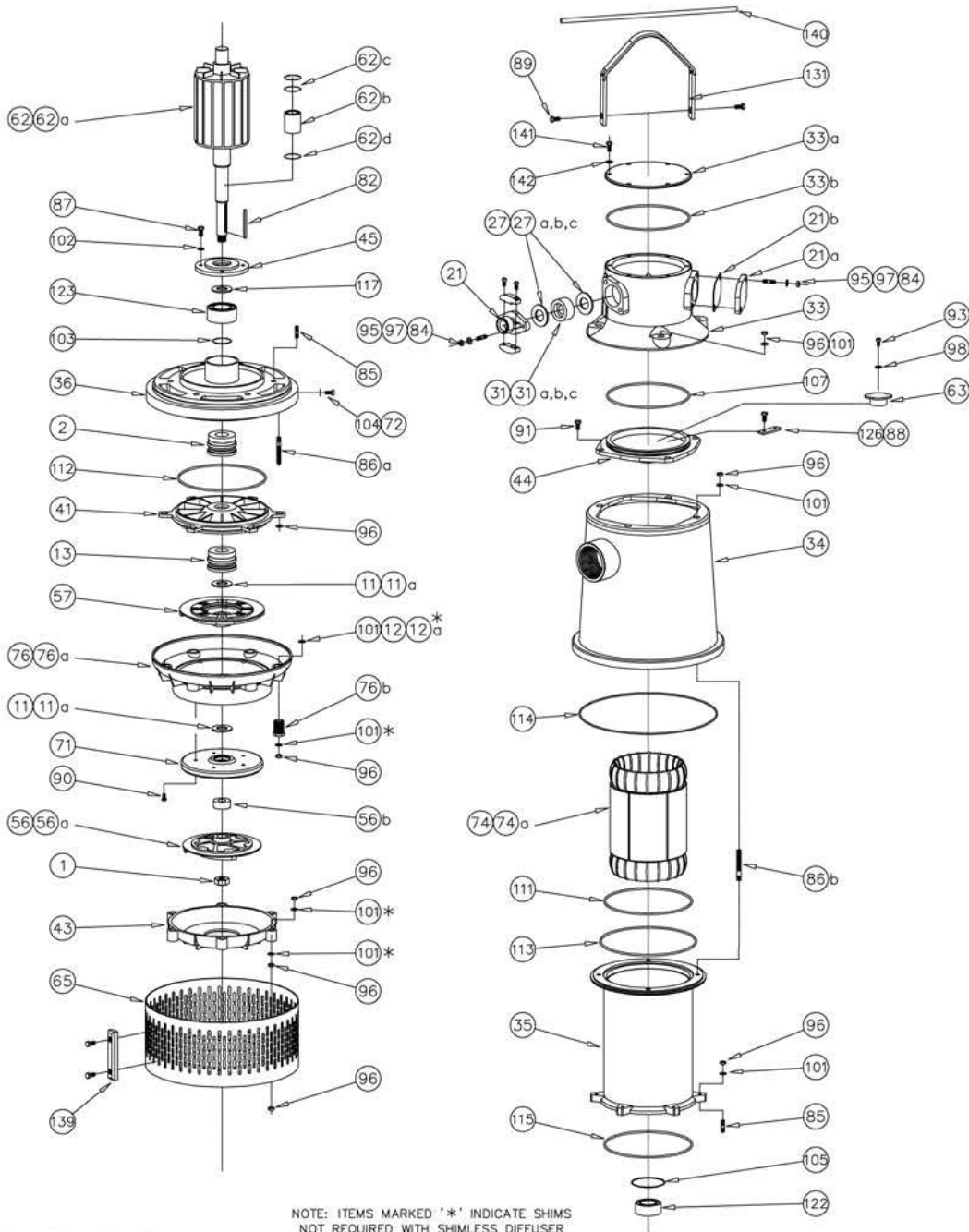

NOTE: ITEMS MARKED '* *' INDICATE SHIMS
NOT REQUIRED WITH SHIMLESS DIFFUSER
PART No: 08391076A [ITEM #76a]

DO NOT SCALE

ACCESSORIES		
PART No.	DESCRIPTION	CONSISTS OF:
08SK	8kW Rotor Shaft Kit	Item #62C - O-Rings Item #62B - Sleeve Item #62D - Circlip

ACCESSORIES		
PART No.	DESCRIPTION	CONSISTS OF:
08BSK	8kW Bottom Suction Kit	Item #65A - Btm. Suct. Strainer Item #65B - Half Strainer Item #65C - Bolt



ACCESSORIES		
PART No.	DESCRIPTION	CONSISTS OF:
08RK	8kW Repair Kit	Item #2 - Seal Item #13 - Seal Item #103 - Circlip Item #122 - Bearing Item #123 - Bearing + 1x O-Ring Kit #08OK

ACCESSORIES		
PART No.	DESCRIPTION	CONSISTS OF:
08OK	8kW O-Ring Kit	Item #33b - O-Ring Item #104 - O-Ring Item #105 - O-Ring Item #107 - O-Ring Item #111 - O-Ring Item #112 - O-Ring Item #113 - O-Ring Item #114 - O-Ring Item #115 - O-Ring

ENHANCED PERFORMANCE PARTS

ITEM No.	PART No.	DESCRIPTION	MATERIAL	QTY.	ITEM No.	PART No.	DESCRIPTION	MATERIAL	QTY.
1	08120001	Impeller Nut	S/Steel	1	71	08201071	Diffuser Disc	Poly	1
2	08128002	Mechanical Seal	TC	1	72	08130072	Screw Inspection	S/Steel	3
11	08120011	Shim Impeller 0.3mm	S/Steel	-	74	08200074	Stator 415V	-	1
11a	08120011A	Shim Impeller 1.5mm	S/Steel	-	74a	08200074A	Stator 1000V	-	1
12	08120012	Shim Diffuser 0.3mm	S/Steel	-	76	08291076	Diffuser	Alum/Poly	1
12a	08120012A	Shim Diffuser 0.5mm	S/Steel	-	76a	08291076A	Diffuser Shimless	Alum/Poly	1
13	08128002	Mechanical Seal	TC	1	76b	08190076B	Diffuser Adjusting Screw	Aluminium	6
21	08190021	Cable Entry Unit 14-22mm	Aluminium	1	82	08130082	Impeller Key	S/Steel	1
21a	08190021A	Junction Box Flange	Aluminium	1	84	08120084	Stud	S/Steel	4
21b	08190021B	Cable Flange Gasket	N.A.G.	1	85	08120085	Stud	S/Steel	6
27	08120027	Sleeve Washer 14-16mm	S/Steel	2	86a	08120086A	Stud	S/Steel	6
27a	08120027A	Sleeve Washer 16-18mm	S/Steel	2	86b	08120086B	Stud	S/Steel	4
27b	08120027B	Sleeve Washer 18-20mm	S/Steel	2	87	08120087	Screw	S/Steel	4
27c	08120027C	Sleeve Washer 20-22mm	S/Steel	2	88	08120088	Screw	S/Steel	2
31	08102031	Seal Sleeve 14-16mm	Rubber	1	89	08120089	Screw	S/Steel	2
31a	08102031A	Seal Sleeve 16-18mm	Rubber	1	90	08120090	Screw	S/Steel	11
31b	08102031B	Seal Sleeve 18-20mm	Rubber	1	91	08120091	Screw	S/Steel	4
31c	08102031C	Seal Sleeve 20-22mm	Rubber	1	93	08120093	Screw	S/Steel	1
33	08190033	Junction Box	Aluminium	1	95	08120095	Nut	S/Steel	4
33a	08190033A	Junction Box Cover	Aluminium	1	96	08120096	Nut	S/Steel	48
33b	08190033B	O-Ring Junction Box	NBR	1	97	08120097	Washer	S/Steel	4
34	08630034	Outer Casing	S/Steel	1	98	08120098	Washer	S/Steel	1
35	08630035	Stator Casing	Aluminium	1	101	08120101	Washer	S/Steel	42
36	08190036	Bearing Housing Lower	Aluminium	1	102	08120102	Washer Spring	S/Steel	4
41	08191041	Oil Housing	Alum/Poly	1	103	08120103	Circlip	HTS	1
43	08291043	Suction Cover HT	Alum/Poly	1	104	08100104	O-Ring	NBR	3
44	08190044	Bearing Housing Upper	Aluminium	1	105	08100105	O-Ring	NBR	1
45	08190045	Bearing Cover	Aluminium	1	107	08100107	O-Ring	NBR	1
56	08710056	Impeller Lower HT - Std.	Cr27	1	111	08100111	O-Ring	NBR	1
56a	08710056A	Impeller Lower c/w Bush	Cr27	1	112	08100112	O-Ring	NBR	1
56b	08710056B	Impeller Lower Neck Bush	Cr16	1	113	08100113	O-Ring	NBR	1
57	08710057	Impeller Upper HT	Cr27	1	114	08100114	O-Ring	NBR	1
62	08100062	Rotor - Standard	S/Steel	1	115	08100115	O-Ring	NBR	1
62a	08100062A	Rotor - Modified for Shaft Sleeve option	S/Steel	1	117	08100117	Washer Bearing Support	S/Steel	1
62b	08100062B	Shaft Sleeve - suit Modified Rotor Shaft	S/Steel	1	122	08100122	Bearing Upper	-	1
62c	08100062C	O-Ring - suit Shaft Sleeve	NBR	2	123	08100123	Bearing Lower	-	1
62d	08120062D	Shaft Sleeve - Circlip	S/Steel	2	126	08100126	Earthing Plate	S/Steel	1
63	08102063	Lead Through	Rubber	1	131	08100131	Handle	Galv. St.	1
65	08100065	Standard Strainer	Galv/St	1	139	GP2400139	Anode	Zinc	4
65a	08100065A	Bottom Suction Strainer	Galv/St	1	140	08600140	Carry Handle	Galv/St	1
65b	08100065B	Half Strainer	Galv/St	1	141	08120141	Screw	S/Steel	6
65c	08100065C	Bolt	Galv/St	3	142	08120142	Washer	S/Steel	6

SUPPLIED BY:

INFORMATION ON THIS DOCUMENT IS SUBJECT TO CHANGE WITHOUT NOTICE

Title **PUMPENG 8kW HIGH HEAD SUBMERSIBLE DEWATERING PUMP**

Rev. 3 Sept. '07



Unit 2/26 Ilda Rd.
Canning Vale. W.A. 6155
PO Box 1340
Canning Vale. W.A. 6970

Ph: 61 8 9256 3182
Fax: 61 8 9256 3867
Email: sales@pumpeng.com.au
Web: www.pumpeng.com.au